



Baines Way

Grange Park, Northampton

oriordanbond
SALES & LETTINGS



Baines Way

Grange Park
NN4 5DP

PRICE £315,000

This three bedroom town house in the popular area of Grange Park is offered for sale with no onward chain. The property is located close to amenities including Woodland View Primary School, Foxfield Country Park as well as good access to Junction 15 for the M1 and A45.

Accommodation over three floors comprises entrance hall, utility room, shower room and bedroom/study on the ground floor. On the first floor is a sitting/dining room and kitchen. On the second floor are two bedrooms and a family bathroom with en-suite to the master bedroom. Outside is an enclosed rear garden and a driveway to the front providing off road parking leading to an integral garage. Further benefits include gas radiator heating and uPVC double glazing. (B/1273/M)

Additional information

- Council Tax Band: D
- Energy Efficiency Rating: C

Viewing

Viewing strictly by appointment – details below

Disclaimer

O'Riordan Bond Estate Agents Limited has not tested apparatus, equipment, fittings or services and so cannot verify they are in working order. The buyer is advised to obtain verification from their solicitor or surveyor.

O'Riordan Bond Grange Park Sales
01604 432007

grangepark@oriordanbond.co.uk



GROUND FLOOR
424 sq ft. (39.4 sq m.) approx.

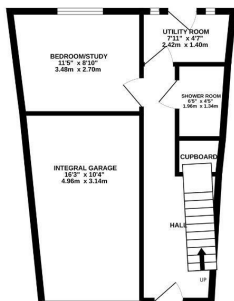

1ST FLOOR
426 sq ft. (39.5 sq m.) approx.

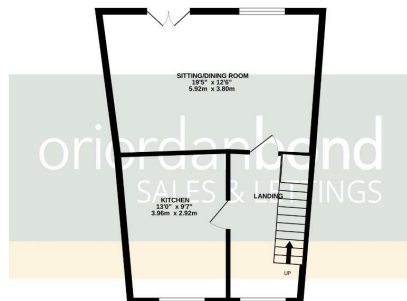

2ND FLOOR
423 sq ft. (39.3 sq m.) approx.

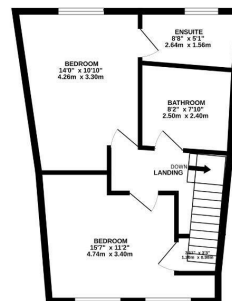

TOTAL FLOOR AREA: 1273 sq ft. (118.2 sq m.) approx.

Whilst every attempt has been made to ensure the accuracy of the floorplan contained here, measurements of doors, windows, rooms and any other items are approximate and no responsibility is taken for any error, omission or mis-statement. This plan is for illustrative purposes only and should be used as such by any prospective purchaser. The services, systems and appliances shown have not been tested and no guarantee as to their operability or efficiency can be given.
Made with Metropix ©2025